

**This electronic collection of documents is provided
for the convenience of the user
and is Not a Certified Document –**

**The documents contained herein were originally issued
and sealed by the individuals whose names and license
numbers appear on each page, on the dates appearing
with their signature on that page.**

**This file or an individual page
shall not be considered a certified document.**

PROJ. REFERENCE NO.	SHEET NO.
WBS 47854	X-1A

STATE OF NORTH CAROLINA DIVISION OF HIGHWAYS **CROSS-SECTION SUMMARY**

NOTE: EMBANKMENT COLUMN DOES NOT INCLUDE BACKFILL FOR UNDERCUT.

EARTHWORK QUANTITIES ARE CALCULATED BY THE ROADWAY DESIGN UNIT. THESE EARTHWORK QUANTITIES ARE BASED IN PART ON SUBSURFACE DATA PROVIDED BY THE GEOTECHNICAL ENGINEERING UNIT.

Approximate quantities only. Unclassified excavation, fine grading, clearing and grubbing, And removal of existing pavement will be paid for at the lump sum price for "Grading".

Station	Uncl. Exc.	Embt																					
L	(cu. yd.)	(cu. yd.)																					
10+25.00	0	0																					
10+50.00	4	16																					
10+75.00	12	83																					
11+00.00	18	95																					
11+25.00	17	40																					
11+50.00	11	21																					
11+75.00	6	10																					
Station	Uncl. Exc.	Embt																					
Y	(cu. yd.)	(cu. yd.)																					
12+55.00	0	0																					
12+75.00	3	7																					
13+00.00	5	10																					
13+25.00	3	8																					
13+50.00	1	4																					
13+75.00	1	12																					
14+00.00	0	49																					
14+25.00	0	80																					
14+50.00	13	125																					
14+75.00	20	164																					
15+00.00	13	158																					
15+25.00	7	120																					
15+50.00	2	52																					

6/23/16

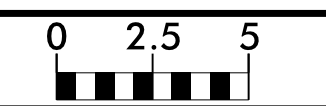

PROJ. REFERENCE NO.	SHEET NO.
WBS 47854	X-1

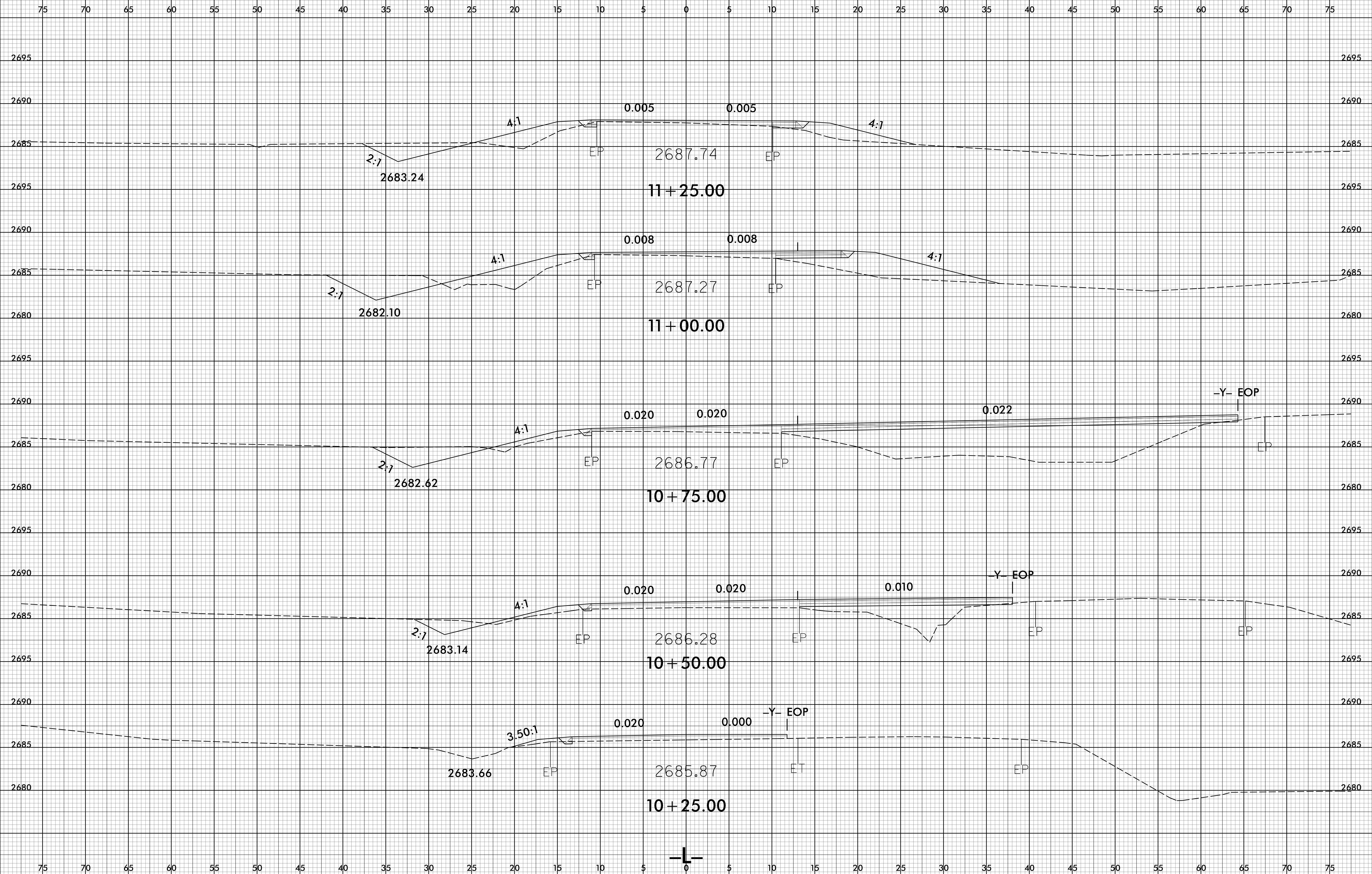

4/26/2019 1:26:09 PM \\Corridor-Modeling\nc215_Rdy_xpl.L.dgn

6/23/16

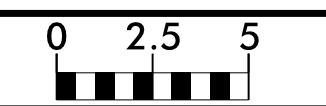

PROJ. REFERENCE NO.	SHEET NO.
WBS 47854	X-2

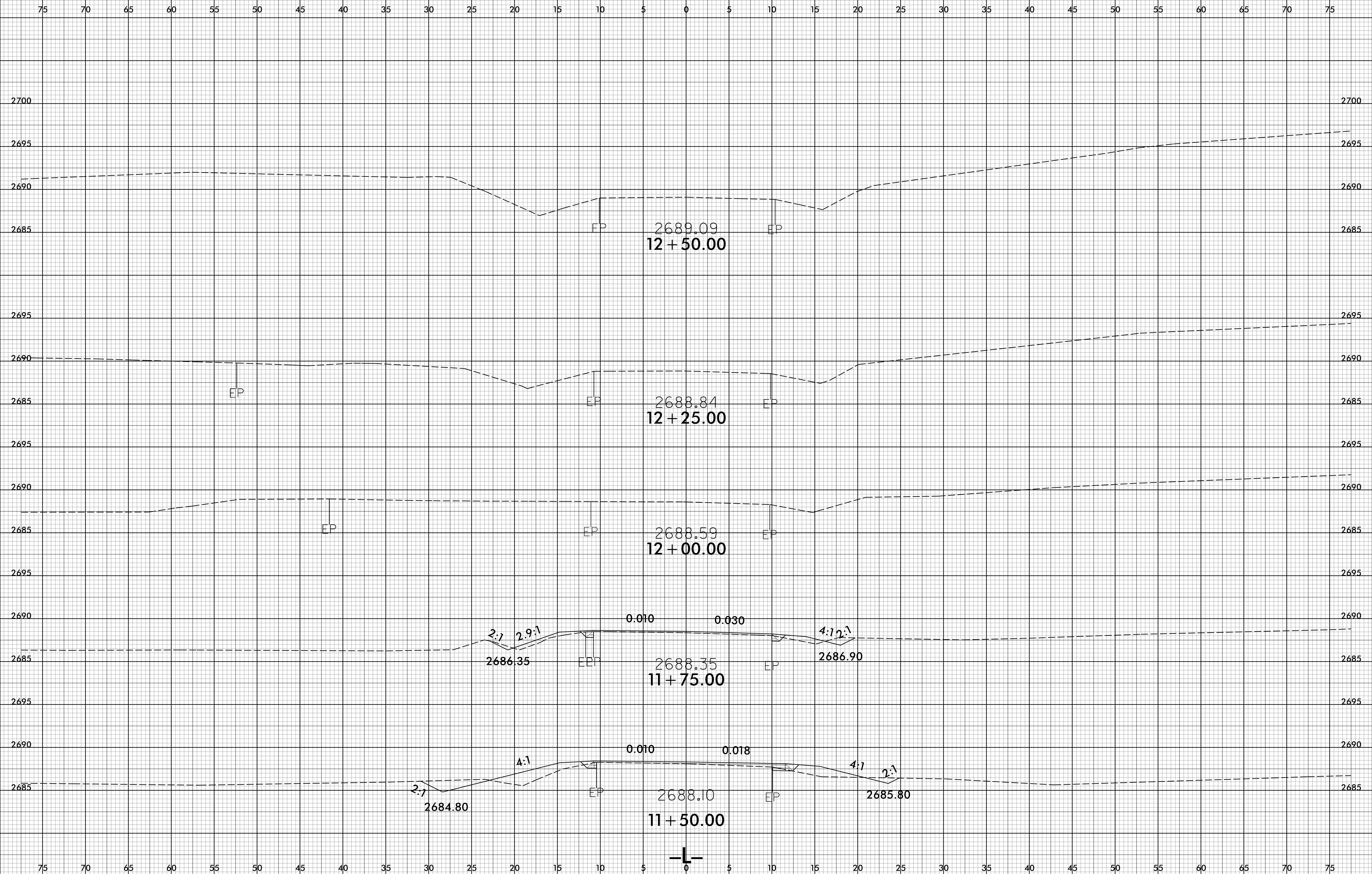

4/26/2019 1:26:41 PM \\corridor-modeling\nc215_rdy_xpl.L.dgn

6/23/16

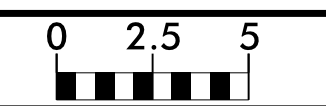

PROJ. REFERENCE NO.	SHEET NO.
WBS 47854	X-3

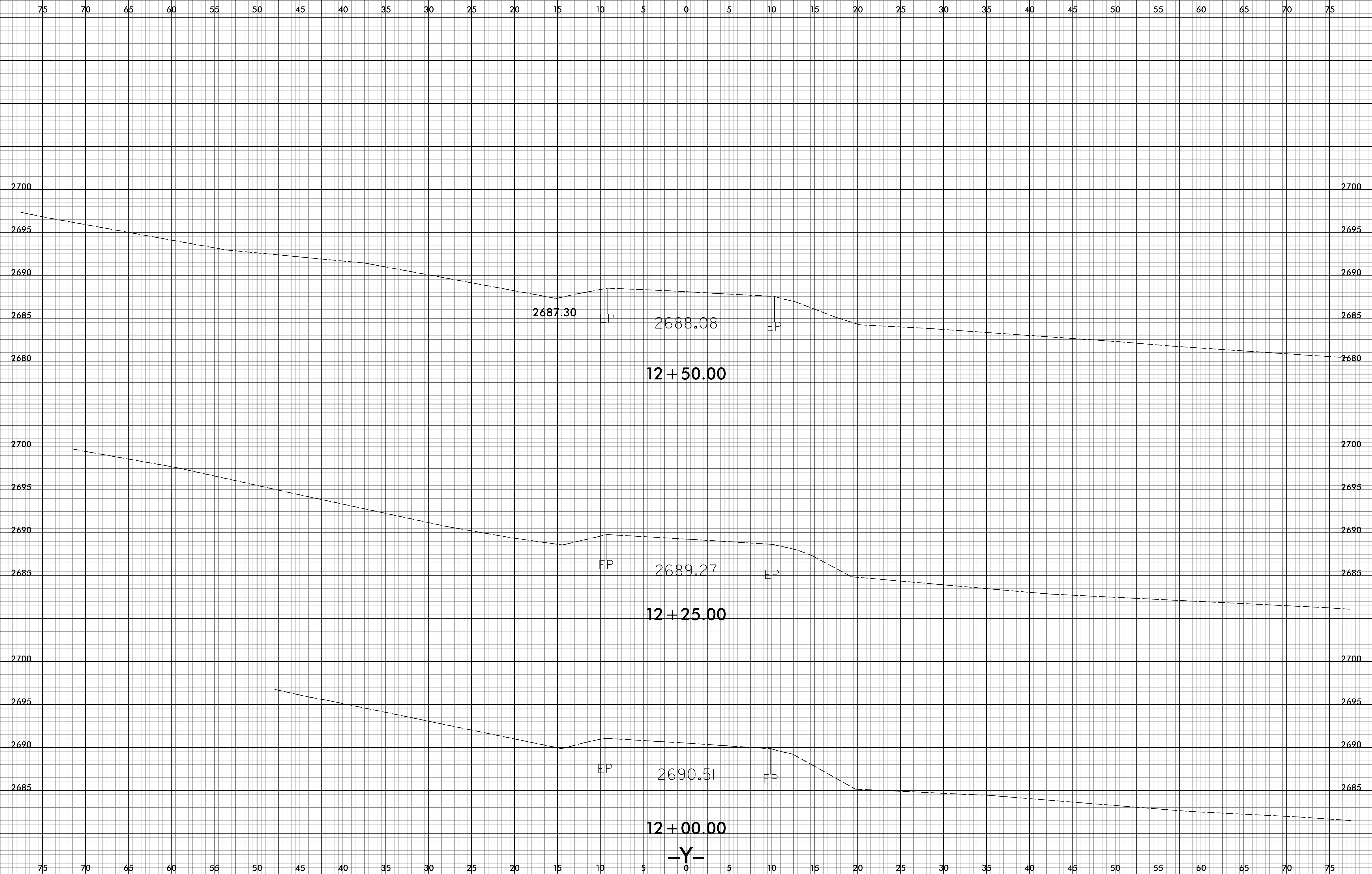

4/26/2019 1:26:45 PM I:\Projects\Corridor-Modeling\nc215_Rdy_xpl.Y.dgn

6/23/16

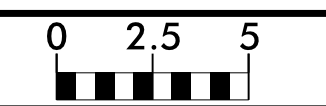

PROJ. REFERENCE NO.	SHEET NO.
WBS 47854	X-4

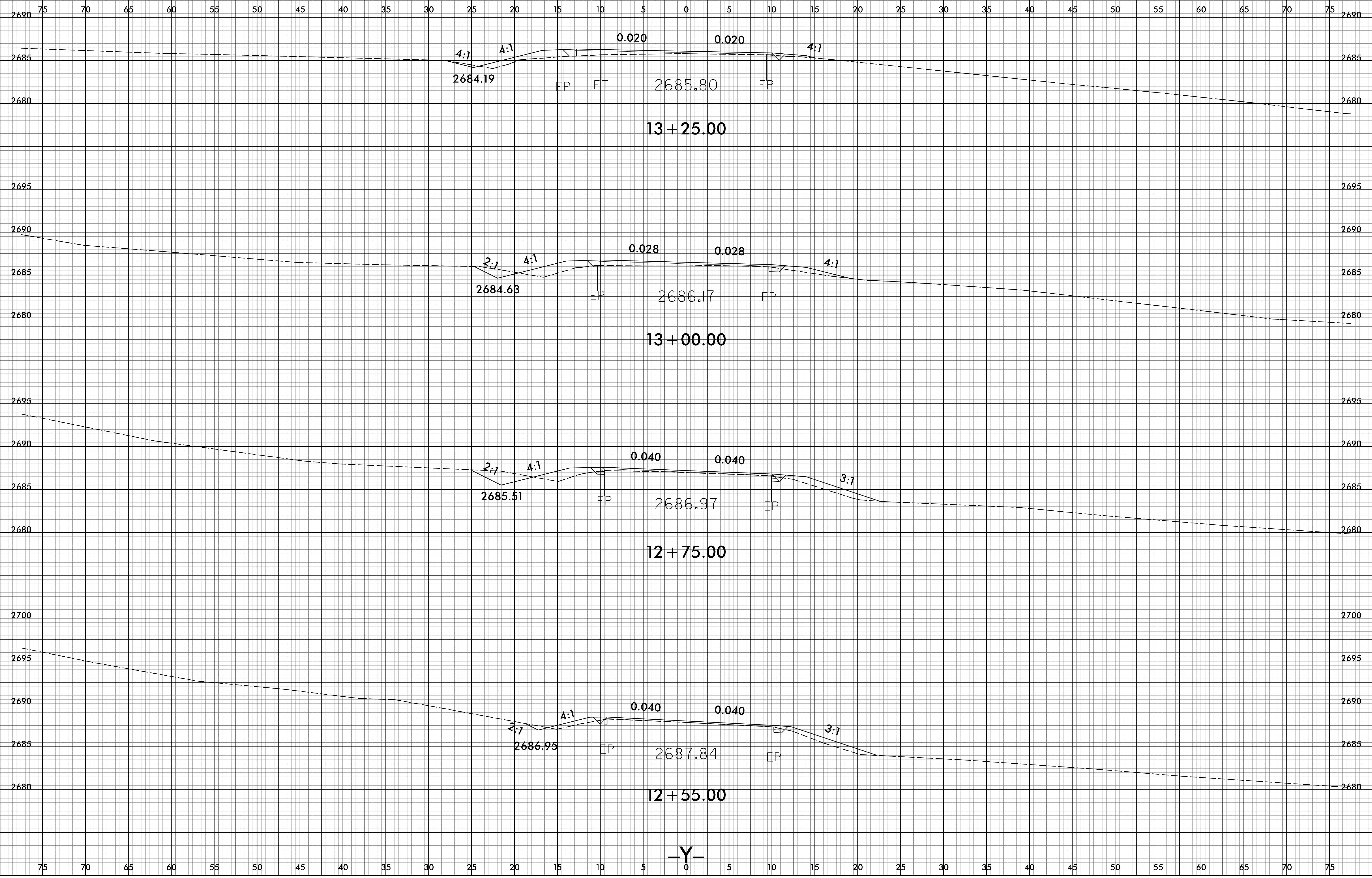

4/26/2019 1:26:48 PM \\Corridor-Modeling\nc215_Rdy_xpl.Y.dgn

6/23/16

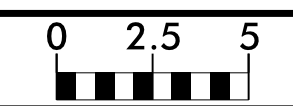

PROJ. REFERENCE NO.	SHEET NO.
WBS 47854	X-5

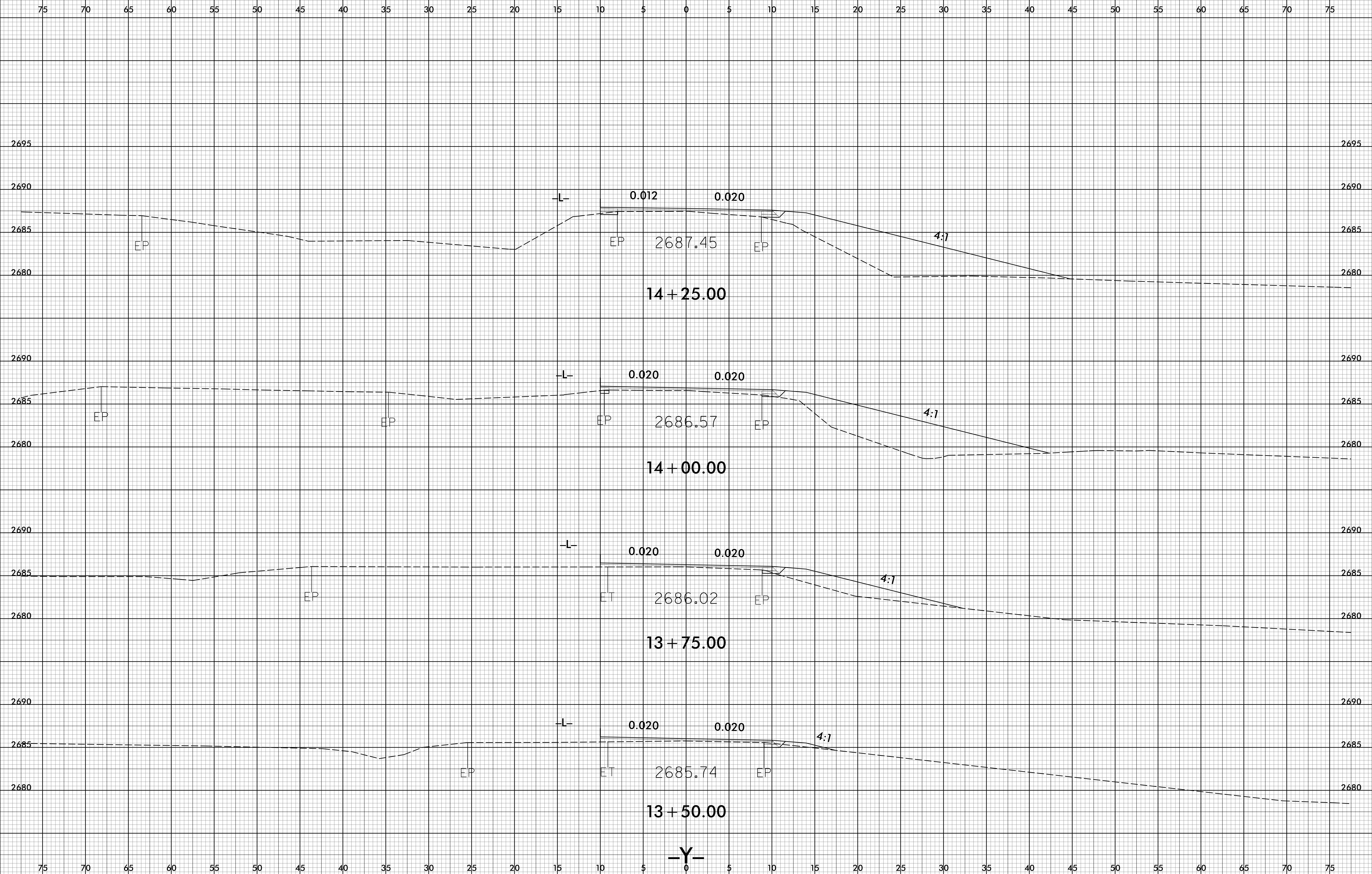

4/26/2019 1:26:49 PM \\Corridor-Modeling\nc215_Rdy_xpl.Y.dgn

6/23/16

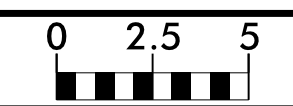

PROJ. REFERENCE NO.	SHEET NO.
WBS 47854	X-6

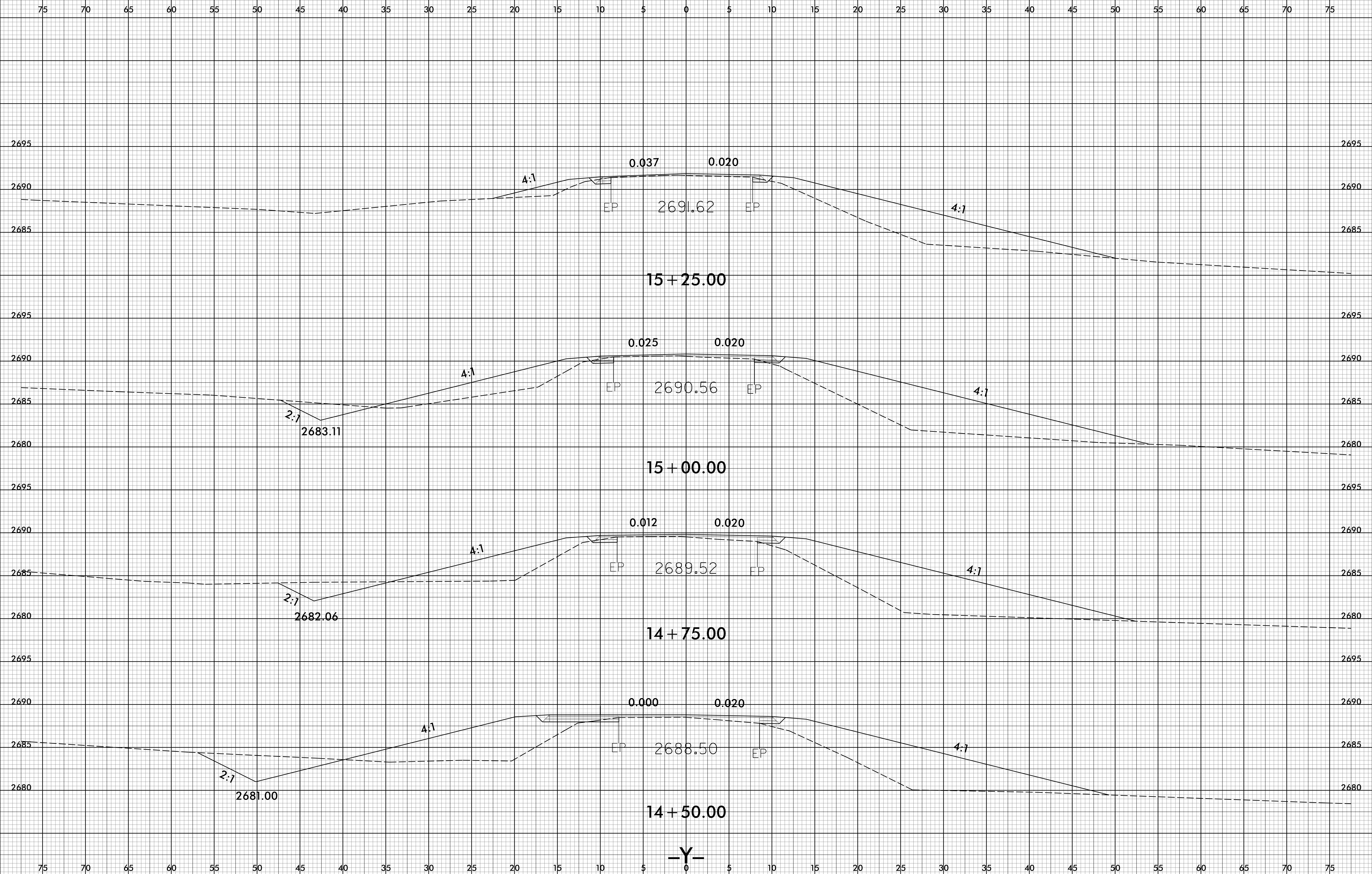

4/26/2019 1:26:50 PM \\Corridor-Modeling\nc215_Rdy_xpl.Y.dgn

6/23/16

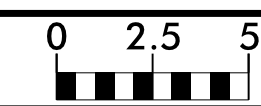

PROJ. REFERENCE NO.	SHEET NO.
WBS 47854	X-7

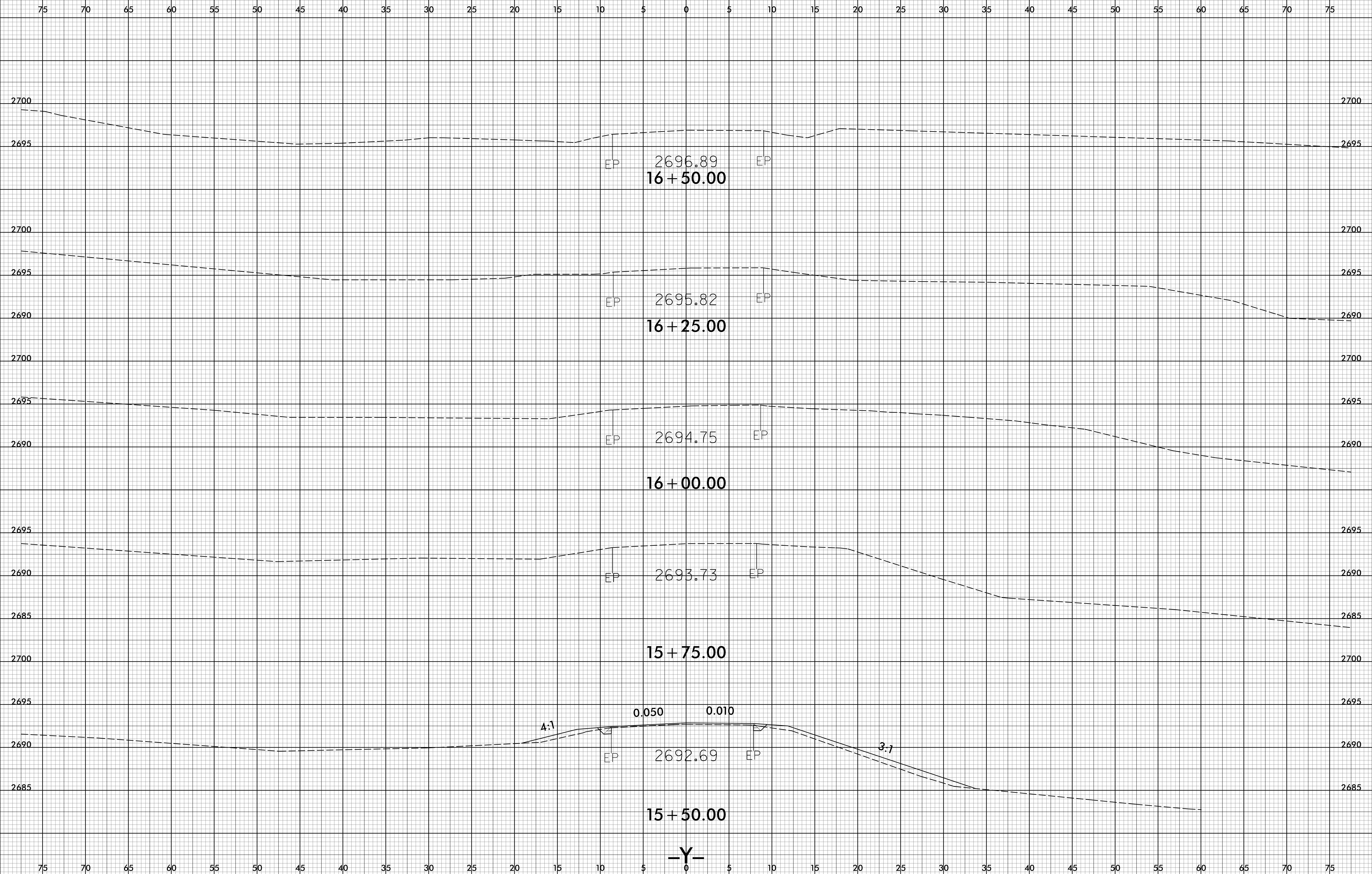

4/26/2019 1:26:53 PM I:\Projects\Corridor-Modeling\nc215_Rdy_xpl_Y.dgn